

PF-65 SERIES

22.5° PROFILE SEPARATOR

FEATURES

- Available in flow rates from 250 to 12,000 GPM.
- Particulate removal efficiencies of 98% at 74 microns and larger expected..
- 150 psi working pressure.
- Fusion bonded polyester coated carbon steel vessel.
- Accumulation chamber clean-out standard.
- True tangential entry.
- Industrial grade manual purge valve.
- 1/4" manual air bleed valve.
- 0-160 psi gauges on inlet/outlet.
- Options: Auto purge, higher pressure ratings, ASME code stamp and stainless steel construction available.

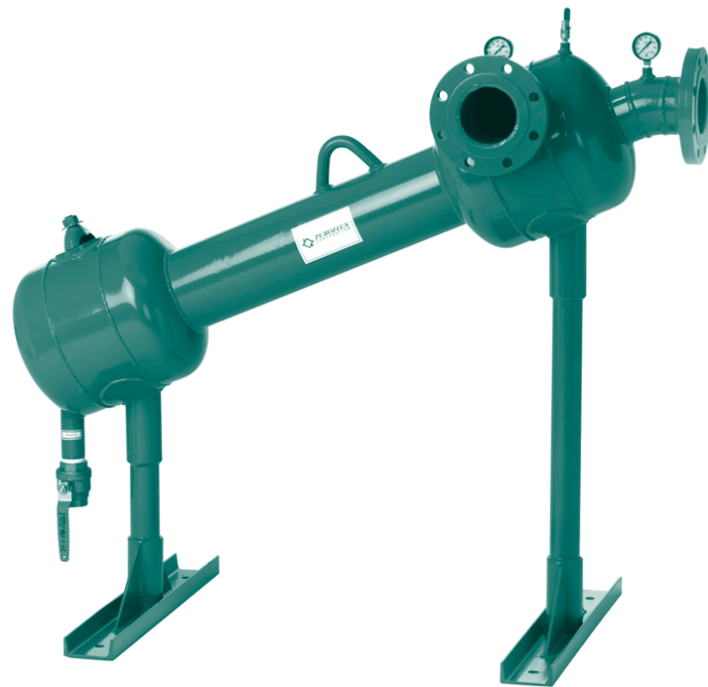

APPLICATION

PUROFLUX's PF-65 series separators are designed specifically to improve the quality of process fluids where space requirements are limited. PF-65 separators provide an excellent method for removing dirt, sand, silt, precipitates and suspended solids from a variety of process fluids.

TYPICAL APPLICATIONS INCLUDE:

- | | | |
|----------------------|-------------------------|------------------------|
| • Cooling Towers | • Well Water | • Industrial Processes |
| • Food Industries | • Waste Water Discharge | • Automotive Processes |
| • Aquatic Exhibits | • Potable Water | • Chemical Processes |
| • Irrigation Systems | • Fish Hatcheries | • Car Washes |

RELIABILITY

The PF-65 series has a simple and reliable design which offers long lasting trouble free service. The simplicity of the PF-65 separator warrants its use when a solid-liquid separation is required. The PF-65 series separators have no moving parts to wear out or replace, eliminating mechanical malfunction or breakdown.

SERVICE

Technical field service representatives are available to provide guidance for application, installation and repair in both domestic and international markets.

VERSATILITY

PUROFLUX's PF-65 series separators can be applied to a variety of applications ranging from single pass/full flow to multiple pass/side stream systems. Optional configurations can be engineered to meet specific requirements.

S-65/03



PF-65 SERIES - 22.5° Profile Separator

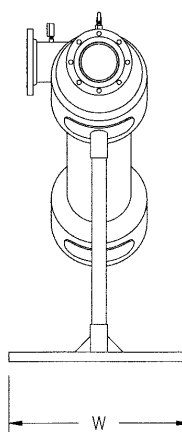
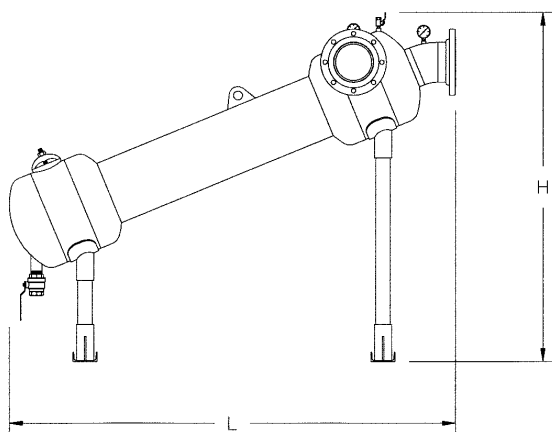

RECOMMENDED DIRECTION
OF INLET/OUTLET PIPING
TO CONTROL HARMONIC
OSCILLATION

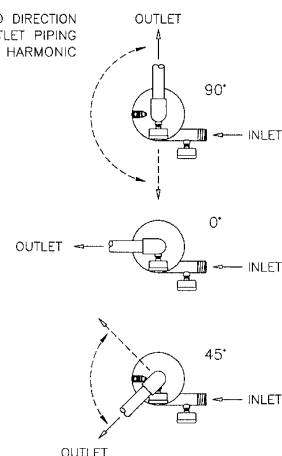

MODEL	FLOW RANGE	CONNECTION	PURGE	VOLUME	DIMENSIONS			WEIGHT, LBS	
Number	GPM	Size	Size	Gallons	L	H	W	Shipping	Oper.
PF-65-040	250 - 475	4" flng	1 1/2" fpt	12	55"	49"	30"	200	300
PF-65-050	350 - 675	5" flng	1 1/2" fpt	19	63"	53"	30"	278	436
PF-65-060	645 - 1200	6" flng	1 1/2" fpt	32	74"	58"	30"	410	675
PF-65-080	850 - 1625	8" flng	1 1/2" fpt	52	87"	69"	40"	625	1056
PF-65-100	1600 - 3100	10" flng	2" fpt	98	104"	82"	40"	1056	1870

Consult factory for larger sizes not shown.

Flow Rate vs. Pressure Loss

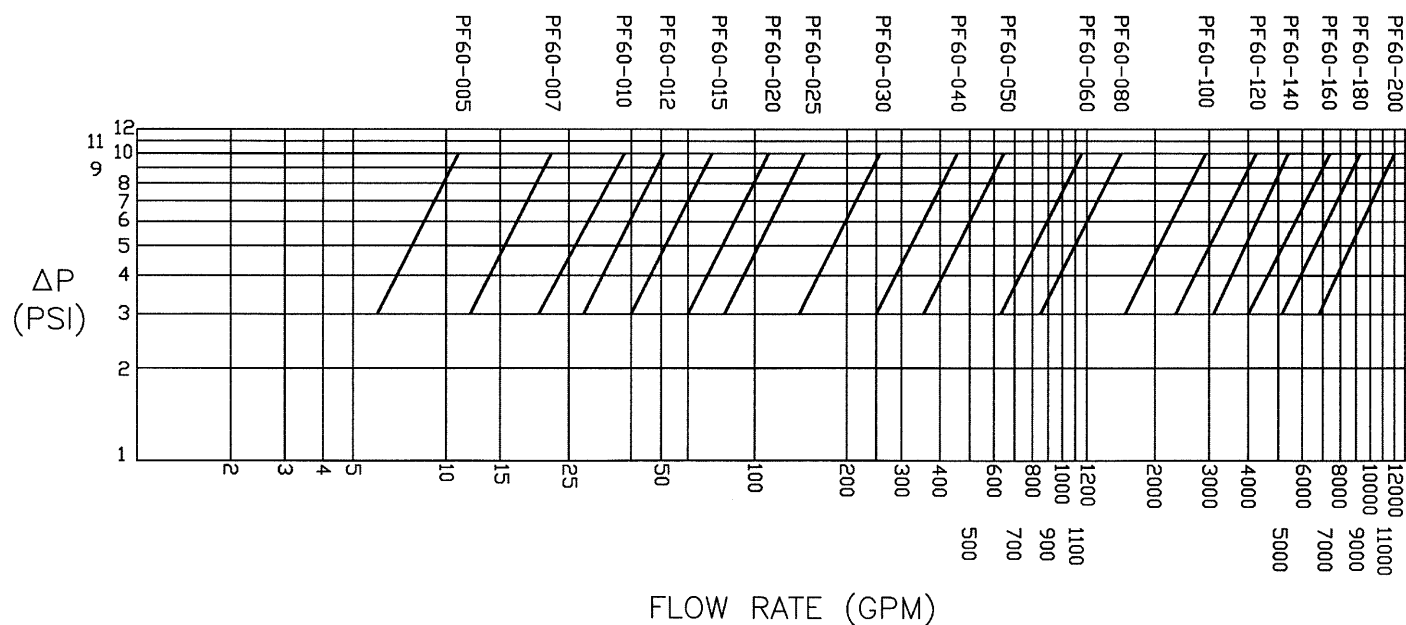

(805) 579-0216 Fax: 579-6005
website: www.puroflux.com • e-mail: sales@puroflux.com